

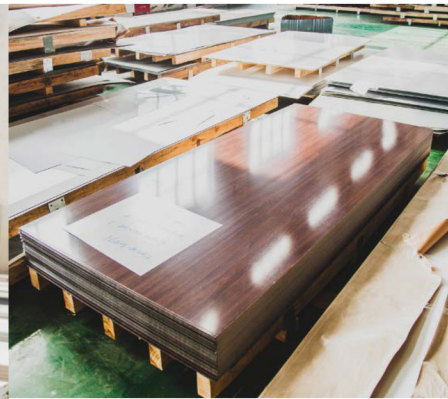

marineusedgood

Marine Panel



0086 15608325156 (whatsapp)

info@marineusedgood.com

www.marineusedgood.com

WALL PANEL 围壁板

C型板

Type C Panel

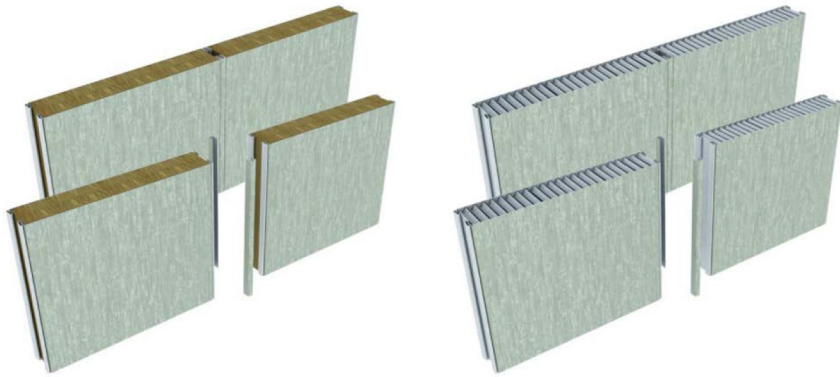

A型板

Type A Panel

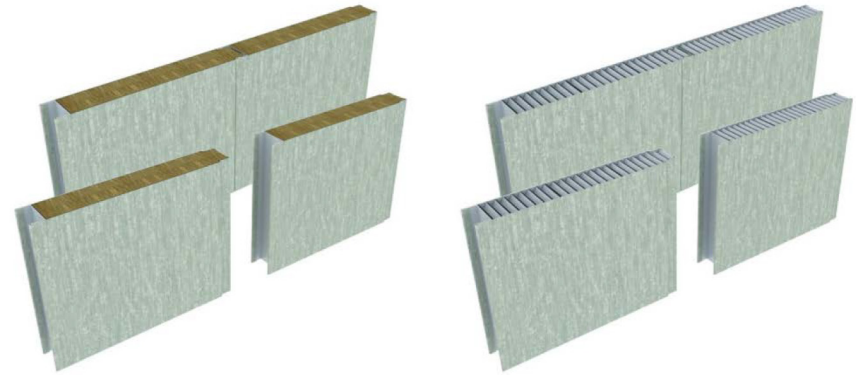

型号 Type No.	JCP-A2	JCP-B1	JCP-B4	JCP-L1	JCP-L1B	JCP-B1-L	JCP-A1
防火级别 Fire class	A-60	B-15	B-15	B-15	B-0	B-15	A-30
尺寸 Dimension	600/550mm width Required length (Max. 3000mm Length) 宽度600/ 550mm 长度可选 (最长3000mm)						
重量 Weight	26.5Kg/m ²	18.4Kg/m ²	11.4Kg/m ²	15.9Kg/m ²	9.9Kg/m ²	17.8Kg/m ²	33.5Kg/m ²
隔声量 Sound reduction	50dB	35dB	32dB	33dB	30dB	33dB	42dB
导热系数 Thermal transmittance	0.30 Kcal/m ² h°C	0.52 Kcal/m ² h°C	0.50 Kcal/m ² h°C	0.96cal/m ² h°C	0.93cal/m ² h°C	2.25 Kcal/m ² h°C	
面材 Surface finish	PVC/PET/HL-3 film or galvanized 贴 PVC/PET/HL-3钢板 或镀锌板(PVC/PET低播焰)						
公差 To-lerances	Width:±, Height±3, Thickness -± 宽度 -±, 高度±3, 厚度 -±						
芯材 Core materials	Rock Wool	Rock Wool	Glass Wool	Rock Wool	Glass Wool	Aluminum honeycomb+ Fireproof board	Fireproof board
厚度 Thickness	100mm	50mm	50mm	30mm	30mm	50mm	50mm

型号 Type No.	JCP-A3	JCP-B3	JCP-L3	JCP-B3-L	JCP-L3-L	JCP-L2-L
防火级别 Fire class	A-30	B-15	B-15	B-15	B-0	B-0
尺寸 Dimension	600/550mm width Required length (Max. 3000mm Length) 宽度600/ 550mm 长度可选 (最长3000mm)					
重量 Weight	26.8Kg/m ²	18.6Kg/m ²	15.7Kg/m ²	17.8Kg/m ²	11.3Kg/m ²	10.9Kg/m ²
隔声量 Sound reduction	50dB	35dB	31dB	33dB	31dB	30dB
导热系数 Thermal transmittance	0.30 Kcal/m ² h°C	0.52 Kcal/m ² h°C	0.50 Kcal/m ² h°C	2.25 Kcal/m ² h°C	3.25 Kcal/m ² h°C	3.25 Kcal/m ² h°C
面材 Surface finish	PVC/PET/HL-3 film or galvanized 贴 PVC/PET/HL-3钢板 或镀锌板(PVC/PET低播焰)					
公差 To-lerances	Width:±, Height±3, Thickness -± 宽度 -±, 高度±3, 厚度 -±					
芯材 Core materials	Rock Wool	Rock Wool	Rock Wool	Aluminum honeycomb+ Fireproof board	Aluminum honeycomb	Aluminum honeycomb
厚度 Thickness	100mm	50mm	25mm	50mm	30mm	25mm



marineusedgood

A/C型板(隔音板)

Type A/C Acoustic Panel



A型微孔吸音板

Type A perforated Sound Reduction Panel

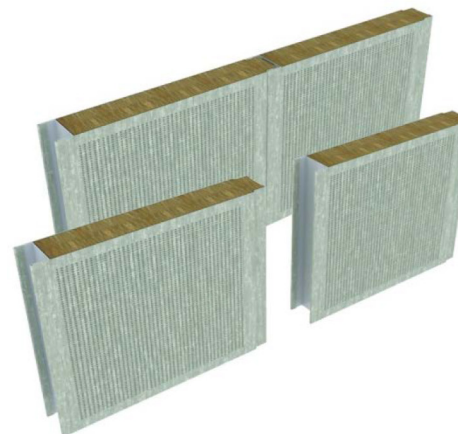

A/C型板(双层隔音板)

Type A/C Acoustic Double Panel

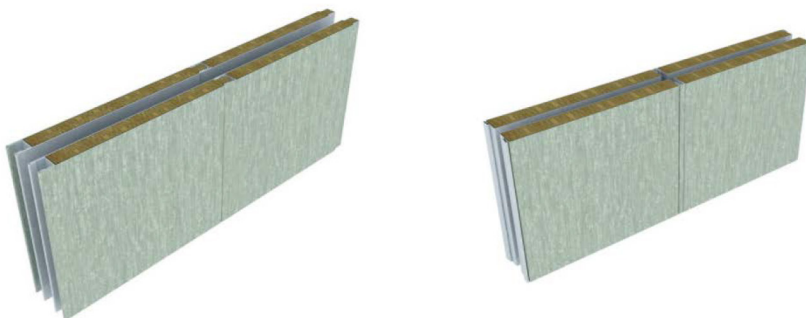



marineusedgood

CORNER PANEL

A型板T型转角板

Type A Panel T corner



A型板L型转角板

Type A Panel L corner



A型板L型转角板(圆角)

Type A Panel L corner(round angle)



C型板T型转角板

Type C Panel T corner



C型板L型转角板

Type C Panel L corner

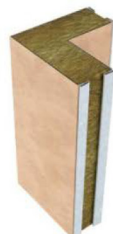

C型板L型转角板(圆角)

Type C Panel L corner(round angle)



防潮板

Wet room Panel

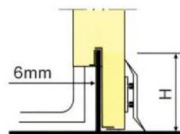

50mm Panels for Division Bulkhead Between Wet Room and Cabin Room

潮湿房间—舱室

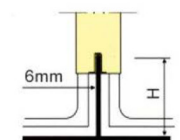

50mm Panels for Division Bulkhead Between Wet Rooms

潮湿房间—潮湿房间

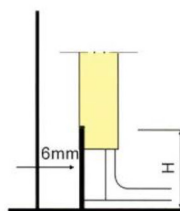

30mm Panels for Lining Bulkhead Between the Steel Wall and Wet Room

钢围壁—潮湿房间

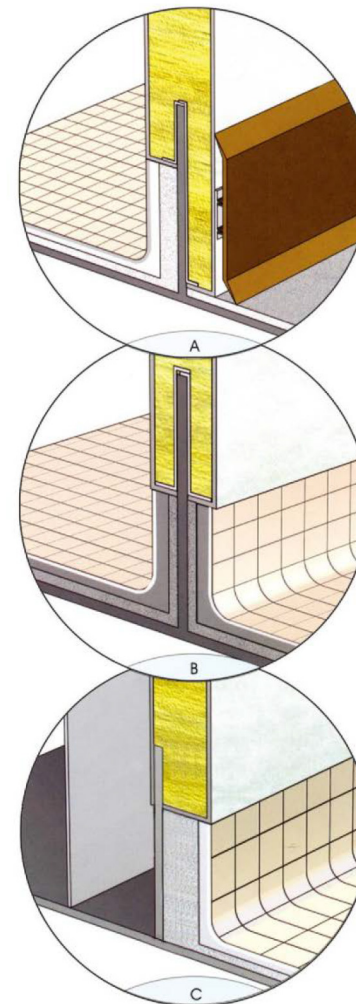



marineusedgood

CEILING

A型天花板

Type A Ceiling Panel



A型铝蜂窝天花板

Type A Aluminum Cellular Ceiling Panel



D型天花板

Type D Ceiling Panel



方块型天花板

Square Ceiling Panel

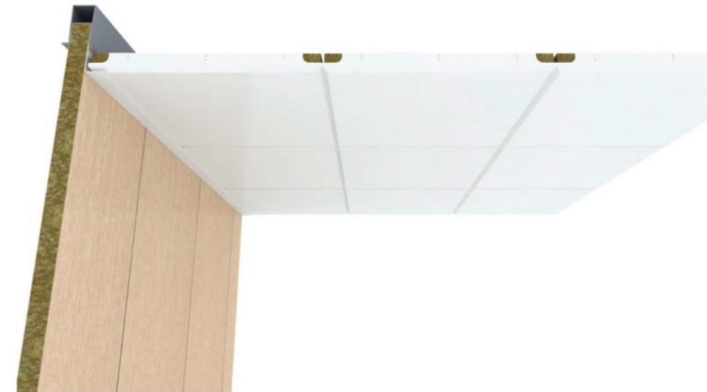



marineusedgood

Fire doors

A-60级双扇防火门

Class A-60 Double-leaf fireproof door



型号 Type No.	CGFM-1A
防火级别 Fire class	A-60
尺寸 Dimension	2200*2000
门扇 Door leaf	PVC/PET/HL-3 film or galvanized 贴 PVC/PET/HL-3钢板 或镀锌板(PVC/PET贴膜贴)
门框 Door Frame	钢板表面喷漆/不锈钢钢板 Powder Painted Steel/Sus
门扇厚度 Door-leaf Thickness	50mm
门扇带附件 Door-leaf Thickness	观察窗400*400,消防孔150*150 Vision Window 400*400 Fire Hoseport 150*150
芯材 Core materials	防火板 Fireproof Board

A-60级单扇防火门

Class A-60 Single-leaf fireproof door



型号 Type No.	CGFM-1	CGFM-1X	CGFM-1H	
防火级别 Fire class	A-60	A-60	A-60	
尺寸 Dimension	2400*1200	2100*1000	2200*950	
门扇 Door leaf	PVC/PET/HL-3 film or galvanized 贴 PVC/PET/HL-3钢板 或镀锌板(PVC/PET贴膜贴)			
门框 Door Frame	钢板表面喷漆/不锈钢钢板 Powder Painted Steel/Sus			
门扇厚度 Door-leaf Thickness	40mm	40mm	40mm	
门扇带附件 Door-leaf Thickness	观察窗400*400,消防孔150*150, 逃口540*440 Vision Window 400*400 Fire Hoseport 150*150 Escape Louver 540*440			
芯材 Core materials	防火板 Fireproof Board			



marineusedgood

Fire doors

A-15/A-0级单扇防火门

Class A-15/A-0 Single-leaf fireproof door



B-15级单扇防火门

Class B-15 Single-leaf fireproof door



型号 Type No.	CGFM-2	CGFM-2X	
防火级别 Fire class	A-15/A-0	A-0	
尺寸 Dimension	2400*1200	2100*1000	
门扇 Door leaf	PVC/PET/HL-3 film or galvanized 贴 PVC/PET/HL-3钢板 或镀锌板(PVC/PET 夹撞贴)		
门框 Door Frame	钢板表面喷塑/不锈钢钢板 Powder Painted Steel/SS		
门扇厚度 Door-leaf Thickness	40mm	40mm	
门扇带附件Door-leaf Thickness			
芯材 Core materials	岩棉 Rock wool		

型号 Type No.	CGFM-3
防火级别 Fire class	B-15
尺寸 Dimension	2100*960
门扇 Door leaf	PVC/PET/HL-3 film or galvanized 贴 PVC/PET/HL-3钢板 或镀锌板(PVC/PET 夹撞贴)
门框 Door Frame	钢板表面喷塑/不锈钢钢板 Powder Painted Steel/SS
门扇厚度 Door-leaf Thickness	40mm
门扇带附件Door-leaf Thickness	双视窗400*400 消防孔150*150、 进出口宽540*440 Visor Window 400*400 Fire Hooport 150*150 Ventilation Louver with Kick-out Panel 540*440
芯材 Core materials	岩棉 Rock wool